

An aerial architectural rendering of the Central Phuket mall complex. The main building is a large, modern structure with a curved facade and a flat roof. A curved walkway or ramp leads from the building towards a landscaped area with trees and a curved road. In the background, there are lush green hills under a clear sky. The overall scene is presented in a dark, semi-transparent overlay.

CENTRAL PHUKET

AUSTCHAM THAILAND
PHUKET MEMBER BRIEFING

15 August 2018

CENTRAL PHUKET

Total Investment
Valued

20,000
Million (BHT)

Land

111
Rais

Leasable Area

185,000
Square Meters

Gross Floor Area

400,000
Square Meters

* Subject to Change

CENTRAL PHUKET



THE HEART OF PHUKET

Main Commercial District

New CBD

Smart Transit

Smart Tourism (Premium Tourist)

THE LOCATION

CENTRAL PHUKET

Approx. **5** Millions

DOMESTIC

50%



Thai Residents



Thai Travelers



The Expats

Approx. **10** Millions

INTERNATIONAL

50%

GROUP Tour & FIT



Chinese



Russian



Korean

TARGET MARKET

CENTRAL PHUKET

THE MAGNITUDE OF 'LUXURY x LEISURE'
RESORT SHOPPING DESTINATION

FLORESTA

FESTIVAL



* Subject to Change

FLORESTA



LUXURY MEETS NATURE

* Subject to Change

TALES OF THAILAND



Where you can experience Thai essence and culture

* Subject to Change

TRIBHUM



The World First 3D Walkthrough Adventure Theme Park

* Subject to Change

AQUARIA

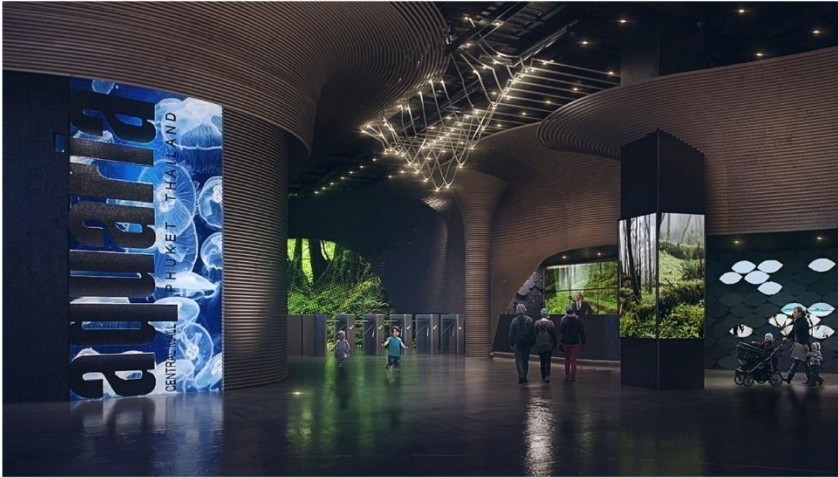

The Newest Format of Aquarium in Thailand

* Subject to Change

FESTIVAL



ANDAMAN TREASURE

* Subject to Change

CENTRAL
PHUKET

THE WORLD
COMES TO PLAY

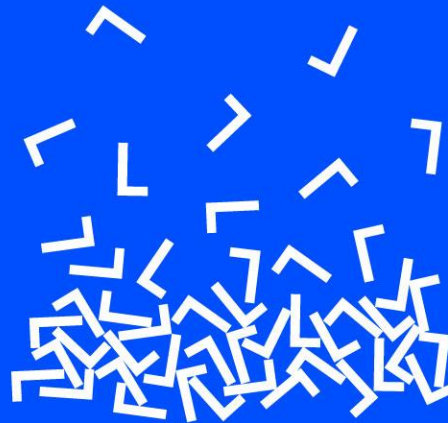

CENTRAL PHUKET

FIRST TIME IN THAILAND



Innovative Live Performance
with 360 Degree Theatrical Experiences by **CREATIVIVA** from Canada
SHOW CREATION WORLDWIDE

10-16 SEPTEMBER 2018

* Subject to Change

CENTRAL PHUKET



PHUKET INTERNATIONAL COUNTDOWN 2019

*Reference Photo / Subject to change

CENTRAL
PHUKET

TIME TO PLAY

10TH SEPTEMBER 2018